

# PCI Compliant Read Head MMD-1901/1902 – 90mm Track

## Overview:

MMD1901/1902 integrates the magnetic card reader function with data encryption. Upon reception of the magnetic head signals, the card data is recovered, encrypted, and transferred to the external device via universal asynchronous receiver and transmitter (UART) or serial peripheral interface (SPI). It supports up to 3 track card reading at the same time. Signal processing techniques are employed to recover F2F encoded data reliably from head signals with severe fluctuation of signal amplitude, widely varying bit interval, and jittery bit position. The recovered data is encrypted with the 128 bit AES.

## Features:

- ❖ Wide Range of Card Swipe Speeds: from 5 to 150 cm/s
- ❖ Signal Conditioning Adapted to Head Signal
- ❖ Flexible External Interface: UART or SPI
- ❖ ISO/IEC 7811 and Binary Data Format Support
- ❖ Encrypt all Track Data
- ❖ Power Down Mode for Low Power Consumption
- ❖ Full Three Tracks Support
- ❖ Secure Data Transfer with 128 bit AES Encryption: CBC Mode
- ❖ **DUKPT key management** (Derived Unique Key Per Transaction)
- ❖ Digital Signal Processing for Superior Data Recovery Performance
- ❖ Development Kits Available

MMD-1901

MMD-1902

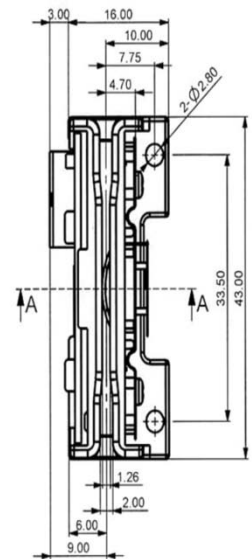
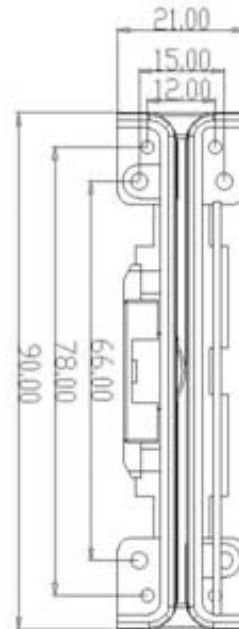

## Technical Specifications:

Card Standard	ISO 7810/7811 and AAMVA
Card Speed	10 ~ 120 cm/sec (4-50 inch/sec)
Head Life Time	300,000 passes minimum
Operating Temperature	-40°C ~ +70°C
Storage Temperature	-40°C ~ +70°C
Power Input	3.0 – 3.6 VDC
Interface	SPI (Option: UART)
Message Format	ASCII